

# ReadySet® Installation Instructions

ASSA ABLOY

## What's included:

- Attachment screws
  - #8 x 1-1/2" Stud screws (11)
  - #8 x 3" SMS Trim attachment screws (4)
  - #8 x 2-1/2" Sill screws (4)
- Silencers (mutes)
- Installation instructions for ReadySet units (per project)
- Installation instructions for hardware (for reference only)
- Loose hardware items (i.e. wall stops)
- ReadySet spacer bar (per project)
- Square bit for trim screws (per project)
- Touchup paint (per project)

## You'll need:

- Level
- Screwdriver with P2 bit
- Flathead screwdriver
- Clamp



Finished Pull Side



Finished Push Side

The global leader in door opening solutions

## A. Position and Install Base Unit



- 1. ReadySet frame is placed in the opening from the pull side.**  
Position unit in front of doorway.



- 4b. On the push side of door, tighten plumb anchors in this order (do not over-tighten):**
  1. Bottom hinge side.
  2. Top lock side.
  3. Bottom lock side.
  4. Top hinge side.Check level and plumb of unit.



- 4c. Keep frame on pull side tight against wall during plumbing process.**



- 5. Install eleven attachment stud screws on push side (self drilling #8 x 1-1/2") through holes in flange in base unit. Do NOT over-tighten beyond contact with flange.**

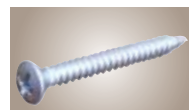

- 6. Remove spreader bar from base of unit and discard. Remove the cardboard door holder from the pull side and discard.**

Spreader bar

Continued on other side

- 2. Remove trim piece, bring to push side of opening, and set aside.**



- 3. Lift base unit and set bottom against opening. Support both the frame and door as the unit is lifted into the opening.**



- 4a. Plumb and check level of unit.**



## B. Install Trim Into Place



- 7.** Install trim piece on the push side. Interlock the hinge side first then move the lock side into place.



- 8.** Use ReadySet spacer to align bottom of frame.

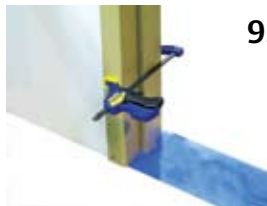

- 9.** Use clamp to pull trim piece tight to base unit, making sure trim tabs engage in slots in base.



- 10.** Install 4 squarehead screws (self drilling #8 x 3") through silencer holes. Do not over-tighten, recommended clutch setting is 5.

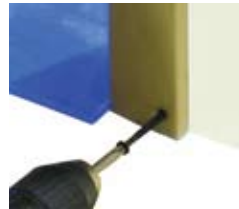

- 11.** Install 4 sill screws (#8 x 2-1/2").



- 12.** Install 4 silencers (mutes).

**NOTE:** Final adjustment steps for hardware components may be necessary. Relevant instructions are included.

### Door Security Solutions®

110 Sargent Drive

New Haven, CT 06511

800.DSS.EZ4U (377.3948) | 203.624.5225

[www.assaabloydss.com](http://www.assaabloydss.com) | [www.readysystem.com](http://www.readysystem.com)



Preassembled. Prefinished. Precise.